



IMAGE MAY VARY FROM ACTUAL PRODUCT

LED ROUND HIGH BAY



PRODUCT DESCRIPTION

LED Round High Bay Light is for workshop, warehouse, indoor stadium or other industrial place. It is an ideal design for high temperature (130°F) environment. Motion sensor can be optional. It is better light distribution, easy installation and 5 years warranty.

SPECIFICATION

Depth: 16.5"
 Height: 17.3"
 Max. Weight: 17.3 lbs

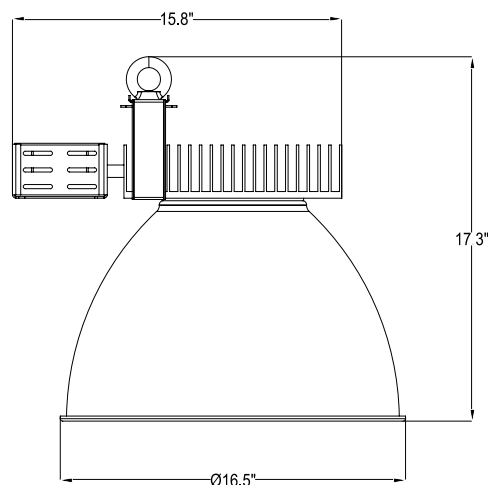

Ordering Information

Example: RHB90501MSO-80

Figure	Watts	CCT	Voltage	Controls	Beam Angle
RHB - Round HighBay	90	50-5000K	1-120V-277V	MS - Hi / Low Motion Sensor MSO - ON/OFF Motion Sensor	80 - 80°
	90 Watts				50 - 50°
	120				
	120 Watts				
	150				
	155 Watts				
	200				
200 Watts					
240					
235 Watts					

* Special Order- Ask Customer Service for Details

Accessories

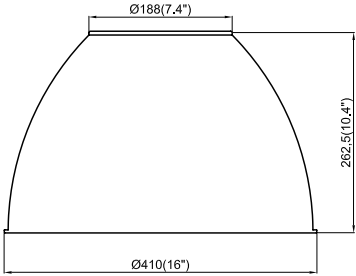
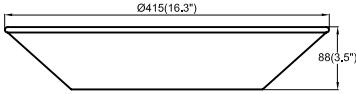
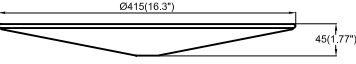
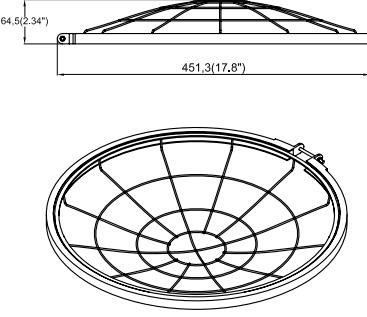
SKU	MODEL	IMAGE	DESCRIPTION
90023	420mm PC Lens		Suitable for Round High Bay 90W, 120W and 150W
90024	Drop Lens		Only use with 420mm PC Lens
90025	Clear Conical Lens		Only Use With 420mm Pc Lens With Ring
90027	Wire Guard		Only Use With Clear Conical Lens

PERFORMANCE DATA

LUMEN OUTPUT

Lumen values are measured by third party certified laboratories performed in accordance with IESNA LM-79-08 as well as Lighting Facts listed.

Watts	Lumen Output	Drive Current	Measured Watts	CRI	Dist. Type	LPW
90W	8500	2.8A	90W	>80	N/A	88
120W	11800	2.8A	120W	>80	N/A	88
155W	14250	2.8A	155W	>80	N/A	88
200W	18400	2.8A	200W	>80	N/A <td 88	
235W	22300	2.8A	235W	>80	N/A	88

Projected LED Lumen Maintenance

Data references the extrapolated performance projections for the LED Round High Bay in a 130F ambient, (tested per IESNA LM-80-08 and projected per IESNA TM-21-11).

Lumen Ambient Temperature (LAT) Multipliers

Use these factors to determine relative lumen output for average ambient temperature from 32-130°F (0-54°C)

Ambient		Multiplier
Celsius	Fahrenheit	
0	32	1.02

Operating Hours	0	6,000	12,000	24,000	70,000
Lumen Maintenance Factor	1.0	0.98(L98)	0.96(L96)	0.92(L92)	0.70(L70)

Photometry

All published luminaire photometric testing performed to IESNA LM-79-08 standards by a NVLAP certified laboratory. Download the IES files at <http://www.abblighting.com/IESfiles>

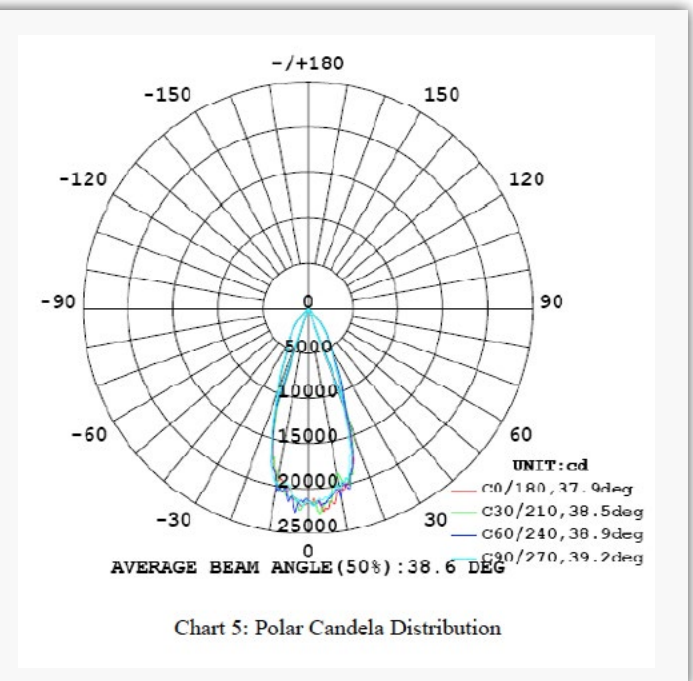
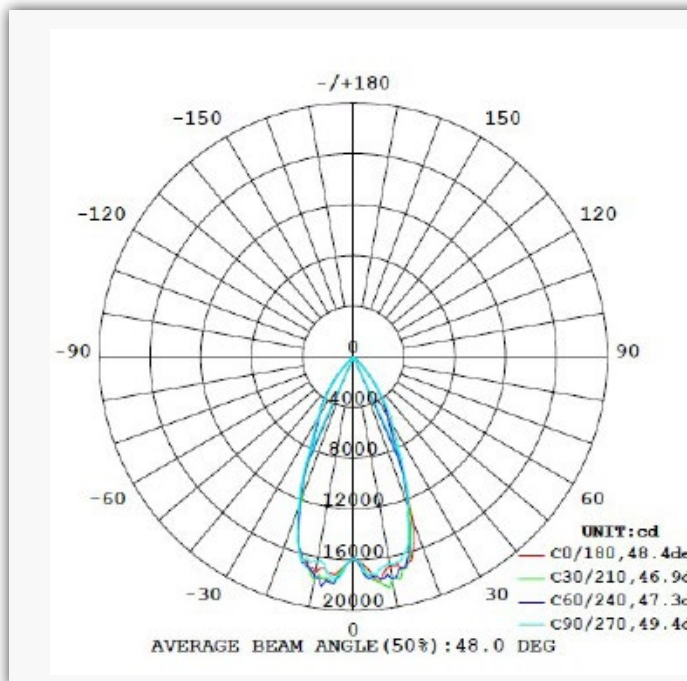

PRODUCT SPECIFICATIONS

ELECTRICAL SYSTEM

- Input Voltage: 120-277V
- 50/60Hz
- Class 1 drivers
- Minimum Ambient -40°
- Power Factor: > 0.98 at full load
- Total Harmonic Distortion: < 20% at full load
- Integral 6KV surge suppression protection standard
- To address inrush current, slow blow fuse or type C/D breaker should be used

System Wattage	Max THD (%)	Power Factor	Power Efficiency
90W	20	>0.9	90%
120W	20	>0.9	90%
155W	20	>0.9	90%
200W	20	>0.9	90%
235W	20	>0.9	90%

Ref#: AB10029-11211

CERTIFICATIONS AND QUALIFICATIONS

- CETLus
- Suitable for damp locations
- Comes standard with 6KV surge suppression protection tested in accordance with IEEE/ANSI C62.41.2
- RoHS compliant

Warranty

Five year limited warranty. Full warranty terms located at www.abblighting.com/warrantystatements

Note: Specifications subject to change without notice.